

Square-flanged type

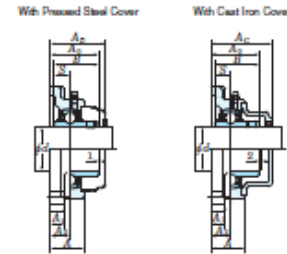

UCF  
Cylindrical bore (with set screws)  
d 12 ~ (45) mm

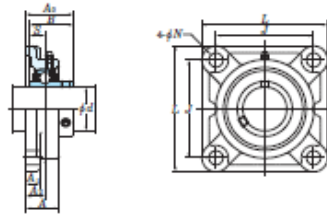

Variations of tolerance of distance from mounting surface to center of spherical bore ( $d_{10}$ ) and tolerance of position of bolt hole (X)

Housing No.	$d_{10}$	X		
F004-F210	F005-F210	F205-F210	±0.5	0.7
F211-F218	F211-F220	F211-F220	±0.8	1

Variations of tolerance of bolt hole diameter ( $d_{10}$ )

Housing No.	$d_{10}$		
F004-F210	F005-F210	F205-F210	±0.2
F220	F220	F220	±0.3

Shaft Dia. mm inch	Dimensions inch mm										Bolt Size inch mm	Standard		Mass kg	Basic Load Ratings kN C <sub>r</sub> C <sub>0r</sub>	Fatigue Load Limit kN C <sub>u</sub>	Factor f <sub>0</sub>	With Pressed Steel Cover		With Cast Iron Cover												
	L	A	J	N	A <sub>1</sub>	A <sub>2</sub>	A <sub>3</sub>	B	S	Unit No.		Housing No.	Bearing No.					Open End Type	Closed End Type	Dimension mm inch	Mass kg	Unit No.	Dimension mm inch	Mass kg								
12												UCF201		UC201	0.64			UCF201C	UCF201D	37.5	1 1/2	0.64										
15												UCF201-8		UC201-8	0.64																	
17	3 1/8	1	2 3/8	1 1/2	1 1/2	1 1/2	1 1/2	1.220	0.500			UCF202	F204	UC202	0.62	12.8	6.66	0.302	13.2	UCF202C	UCF202D	37.5	1 1/2	0.62								
20	86	25.5	64	12	11	15	33.3	31	12.7	M10		UCF203		UC203	0.61					UCF203C	UCF203D	37.5	1 1/2	0.61								
												UCF204-12		UC204-12	0.61																	
												UCF204		UC204	0.59						UCF204C	UCF204D	37.5	1 1/2	0.59	UCF204FC	UCF204FD	46	1 1/2	0.74		
25	3 1/8	1 1/2	2 1/2	1 1/2	1 1/2	1 1/2	1 1/2	1.343	0.563			UCF205-14		UC205-14	0.83																	
	95	27	70	12	13	16	36.8	34.1	14.3	M10		UCF205-15	F205	UC205-15	0.83	14.0	7.85	0.357	13.9	UCF205C	UCF205D	40.5	1 1/2	0.83	UCF205FC	UCF205FD	49	1 1/2	1.0			
												UCF205		UC205	0.83																	
												UCF205-16		UC205-16	0.83																	
	4 1/8	1 1/2	3 1/2	1 1/2	1 1/2	1 1/2	1 1/2	1.500	0.625			UCF305	F205	UC305	1.2					UCF305C	UCF305D	44.5	1 1/2	1.2								
	108	30	83	12	13	16	40.2	38.1	15.9	M10		UCF305-16	F205	UC305-16	1.2	19.5	11.3	0.514	13.9	UCF305C	UCF305D	44.5	1 1/2	1.2								
	4 1/8	1 1/2	3 1/2	1 1/2	1 1/2	1 1/2	1 1/2	1.495	0.591			UCF305		UC305	1.3																	
	110	29	80	16	13	16	39	38	15	M14		UCF305-16		UC305-16	1.3	21.2	10.9	0.495	12.6						UCF305C	UCF305D	54	2 1/8	1.6			
30	4 1/8	1 1/2	3 1/2	1 1/2	1 1/2	1 1/2	1 1/2	1.500	0.625			UCF206-18		UC206-18	1.1																	
	108	31	83	12	13	16	40.2	38.1	15.9	M10		UCF206	F206	UC206	1.1	19.5	11.3	0.514	13.9	UCF206C	UCF206D	44.5	1 1/2	1.1	UCF206FC	UCF206FD	53	2 1/8	1.4			
	1 1/2											UCF206-19		UC206-19	1.1																	
	1 1/2											UCF206-20		UC206-20	1.1																	
	4 3/8	1 1/2	3 1/2	1 1/2	1 1/2	1 1/2	1 1/2	1.689	0.669			UCF306	F206	UC306	1.6	25.7	15.4	0.700	13.9	UCF306C	UCF306D	49	1 1/2	1.6								
	117	34	92	16	14	19	44.4	42.9	17.5	M14		UCF306-19	F206	UC306-19	1.6	25.7	15.4	0.700	13.9	UCF306C	UCF306D	49	1 1/2	1.6								
	4 3/8	1 1/2	3 1/2	1 1/2	1 1/2	1 1/2	1 1/2	1.693	0.669			UCF306		UC306	1.6																	
	125	32	95	16	15	18	44	43	17	M14		UCF306	F206	UC306	1.9	26.7	15.0	0.682	13.3						UCF306C	UCF306D	59	2 1/8	2.2			
35	5 1/8	1 1/2	4 1/2	1 1/2	1 1/2	1 1/2	1 1/2	1.689	0.669			UCF207-20		UC207-20	1.5																	
	130	38	102	16	14	21	51.2	49.2	19	M14		UCF207-21	F207	UC207-21	1.5	25.7	15.4	0.700	13.9													
	1 1/2											UCF207-22		UC207-22	1.5																	
	1 1/2											UCF207		UC207	1.5					UCF207C	UCF207D	49	1 1/2	1.5	UCF207FC	UCF207FD	58	2 1/8	1.9			
	1 1/2											UCF207-23		UC207-23	1.5																	
	5 1/8	1 1/2	4 1/2	1 1/2	1 1/2	1 1/2	1 1/2	1.837	0.748			UCF307-22		UC307-22	2.0																	
	130	38	102	16	14	21	51.2	49.2	19	M14		UCF307	F207	UC307	2.0	29.1	17.8	0.809	14.0	UCF307C	UCF307D	55.5	2 1/8	2.0								
	5 1/8	1 1/2	4 1/2	1 1/2	1 1/2	1 1/2	1 1/2	1.890	0.748			UCF307-23		UC307-23	2.0																	
	135	36	100	19	16	20	49	48	19	M16		UCF307	F207	UC307	2.3	33.4	19.3	0.877	13.2						UCF307C	UCF307D	64	2 1/2	2.7			
40	5 1/8	1 1/2	4 1/2	1 1/2	1 1/2	1 1/2	1 1/2	1.837	0.748			UCF208-24		UC208-24	1.9																	
	130	36	102	16	15	21	51.2	49.2	19	M14		UCF208-25	F208	UC208-25	1.9	29.1	17.8	0.809	14.0													
	1 1/2											UCF208		UC208	1.9					UCF208C	UCF208D	55.5	2 1/8	1.9	UCF208FC	UCF208FD	64	2 1/2	2.3			
	5 3/8	1 1/2	4 1/2	1 1/2	1 1/2	1 1/2	1 1/2	1.937	0.748			UCF308-24		UC308-24	2.4																	
	137	40	105	19	14	22	52.2	49.2	19	M16		UCF308	F208	UC308	2.4	34.1	21.3	0.968	14.0	UCF308C	UCF308D	56.5	2 1/8	2.4								
	5 3/8	1 1/2	4 1/2	1 1/2	1 1/2	1 1/2	1 1/2	2.047	0.748			UCF308-24		UC308-24	3.1																	
	150	40	112	19	17	23	56	52	19	M16		UCF308	F208	UC308	3.1	40.7	24.0	1.09	13.2						UCF308C	UCF308D	71	2 1/2	3.6			
45	5 1/2	1 1/2	4 1/2	1 1/2	1 1/2	1 1/2	1 1/2	1.937	0.748			UCF209-26		UC209-26	2.2																	
	137	38	105	16	16	22	52.2	49.2	19	M14		UCF209-27	F209	UC209-27	2.2	34.1	21.3	0.968	14.0													
	1 1/2											UCF209-28		UC209-28	2.2																	
	1 1/2											UCF209		UC209	2.2					UCF209C	UCF209D	56.5	2 1/8	2.2	UCF209FC	UCF209FD	66	2 1/2	2.6			
	5 1/2	1 1/2	4 1/2	1 1/2	1 1/2	1 1/2	1 1/2	2.031	0.748			UCF309-28		UC309-28	2.7																	
	143	40	111	19	14	23	55.6	51.6	19	M16		UCF309	F209	UC309	2.7	35.1	23.3	1.06	14.4	UCF309C	UCF309D	60	2 1/2	2.7								

Remarks 1. In Part No. of unit and units with covers, fitting codes follow bore diameter numbers. (See Table 2.5 in P.11.)  
2





